

This guide contains information to help prepare your facility for the arrival of your Cascade Microtech, Inc. probe station.

Probe Station Requirements

Air and Vacuum	Vacuum	<ul style="list-style-type: none"> • Less than 200 mbar absolute • Flow rate insignificant • 6 mm hose (US 1/4")
	Compressed air	<ul style="list-style-type: none"> • Filtered, dry and oil-free • Minimum 4 bar to 6 bar maximum • Flow rate insignificant • 6 mm hose (US 1/4")
Dimensions	Station with fixed bridge	750 mm (W) x 700 mm (D) x 527 mm (H)
	Station with moveable bridge	784 mm (W) x 615 mm (D) x 530 mm (H)
	Station with accessories	Optional accessories such as cameras and laser cutters can increase the total height up to 900 mm.
Weight	Station with fixed bridge	130 kg
	Station with moveable bridge	170 kg
Temperature	Operating range	19°C to 24°C
	Target temperature	22°C
	Tolerance	1K
	ProberBench®	Side ventilators and air expellers must be kept clear for air circulation at all times.
Humidity	Tool area	25% to 60%
Vibrations	The facility should be free of vibrations caused by other equipment.	
Electrical Data	Power supply	90–264 VAC, 47–63 Hz, 120VA
	Power for accessories	100–240 V AC nominal, 50/60 Hz (depends on accessories and country/region)
	Facility power line fuse for main connector	Ensure that a 10 A lead fuse is available in your facility power line where the main connector is plugged in.
Pollution Level	1 IEC 664	
Clean Room Class	Class 6 corresponding to DIN EN ISO 14644-1	
Additional Equipment	ProbeShield®	100 mm extra space on each side and the rear for cables; pressurized air required with max. -70°C dew point, min. 6 bar, min. 3000 l/h (air dryer optional)
	Laser cutter	Only required for swivel (interlock switch)
	Thermal chuck	May require a coolant
	ShieldEnclosure® SE1000	1000 mm x 1220 mm x 1275 mm. Extra space is required for access.
	Table	Extra space is required for the PC next to the probe system when equipped with motorized accessories including ProberBench® (optional).
	Vibration table	For dimensions and points of support, see diagrams.

PM8 Manual Probe System

Shipping Dimensions and Weight (approx. values)	Probe station box	<ul style="list-style-type: none"> • 1250 mm x 870 mm x 760 or 1160 mm • Gross weight: 170 or 220 kg
	Accessories box	<ul style="list-style-type: none"> • 800 mm x 1200 mm x 800 mm (typical) • Gross weight: 120 kg
	VIT box	<ul style="list-style-type: none"> • 1000 mm (W) x 1000 mm (D) x 1050 mm (H) • Gross weight 245 kg <p>With Dark Box adaption:</p> <ul style="list-style-type: none"> • 1500 mm (W) x 1400 mm (D) x 1120 mm (H) • Gross weight 260 kg

Dimensions (in mm)

PM8 with Moveable Bridge

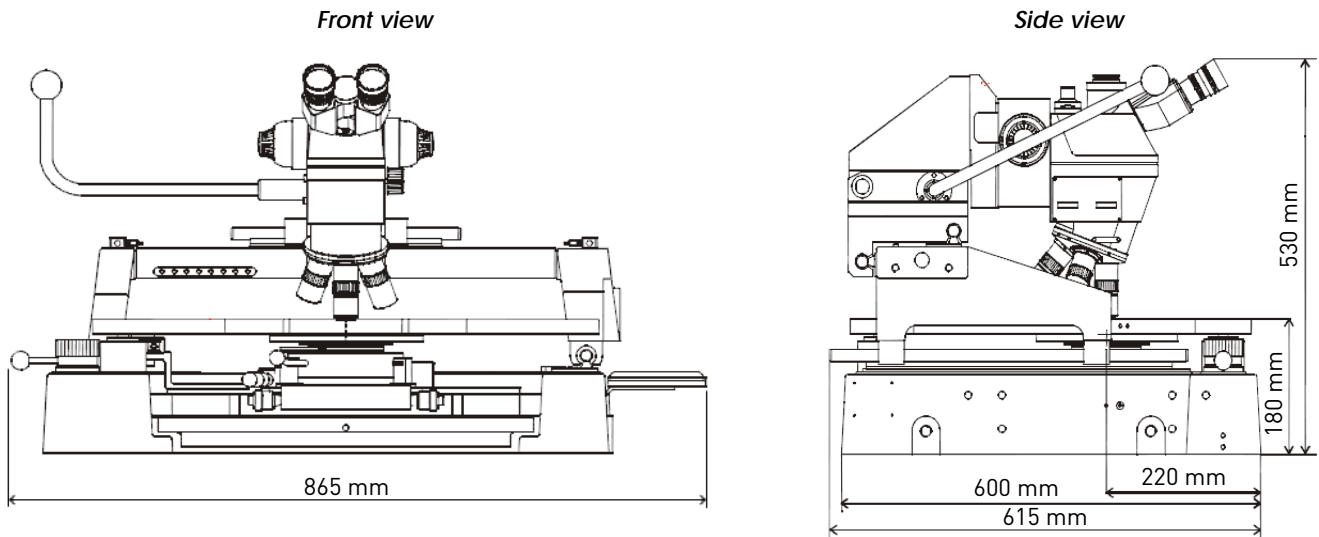

PM8 with Fixed Bridge

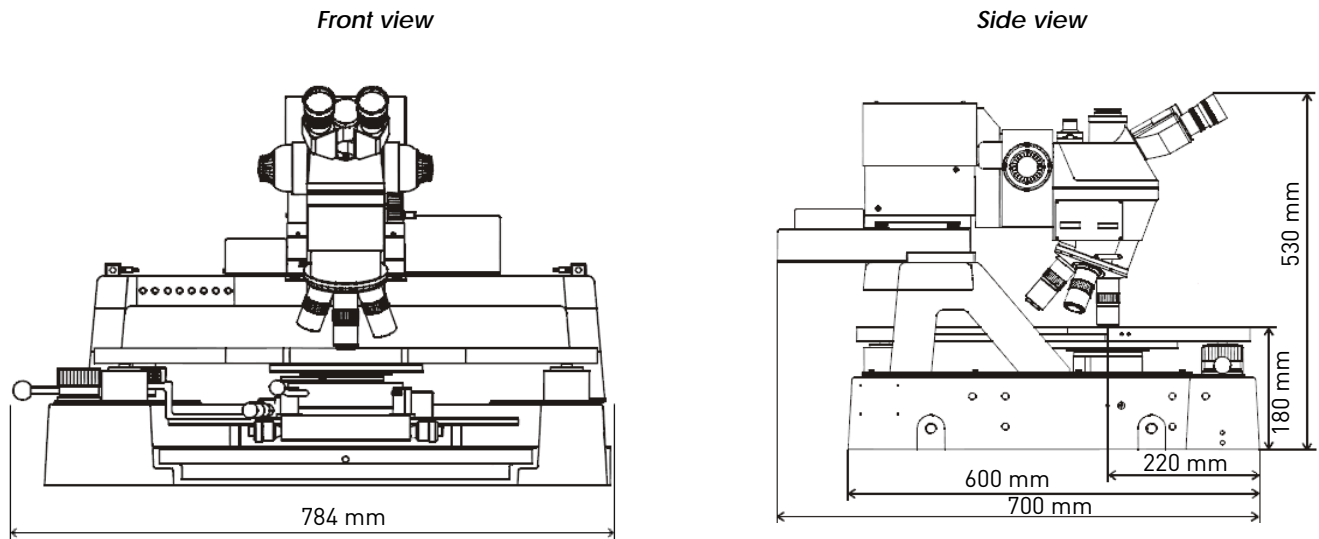

PM8 Manual Probe System

Vibration Isolation Tables

VIT 800

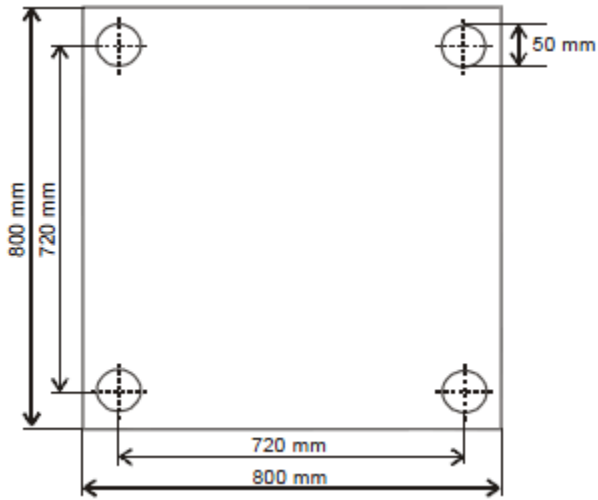

VIT 801/VIT 802/VIT 881

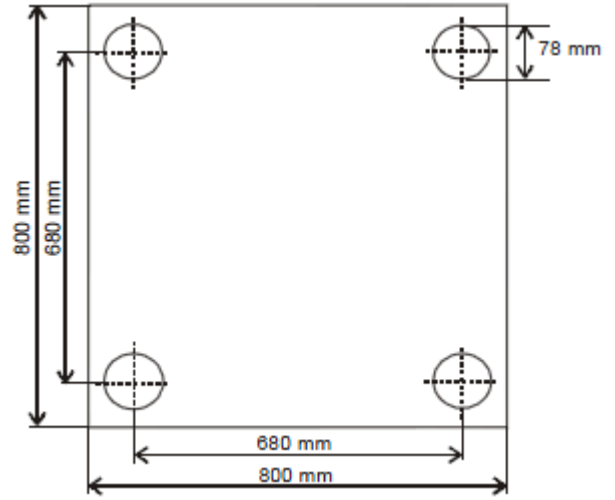

© Copyright 2011 Cascade Microtech, Inc. All rights reserved. Cascade Microtech is a registered trademark of Cascade Microtech, Inc. All other trademarks are the property of their respective owners.

Data subject to change without notice.

Cascade Microtech, Inc.
Corporate Headquarters
toll free: +1-800-550-3279
phone: +1-503-601-1000
email: cmj_sales@cmicro.com

Germany
phone: +49-89-9090195-0
email: cmg_sales@cmicro.com

Japan
phone: +81-3-5615-5150
email: cmj_sales@cmicro.com

China
phone: +86-21-3330-3188
email: cmc_sales@cmicro.com

Singapore
phone: +65-6873-7482
email: cms_sales@cmicro.com

Taiwan
phone: +886-3-5722810
email: cmt_sales@cmicro.com

